

4. Coples

4.1 COPLES REDUCTORES

CAJA A CAJA



Ref.	Conexión		No.Parte
	Barra Macho	Barra Macho	
11	AW	AQ	8-C-52261
12	AW	BQ	8-C-52262
13	NW	NQ	8-C-52263
14	NW	HQ	8-C-52264
15	AW	AXWL	8-C-52265
16	AW	BXWL	8-C-52266
17	NW	NXWL	8-C-52267
18	AQ	BQ	8-C-52268
19	AQ	NQ	8-C-52269
20	NQ	HQ	8-C-52270
21	AQ	AW	8-C-52271
22	BQ	NW	8-C-52272
23	NQ	NW	8-C-52273
24	AQ	AXWL	8-C-52274
25	BQ	BXWL	8-C-52275
26	NQ	NXWL	8-C-52276
27	EW	AW	8-C-52277
28	AW	BW	8-C-52278
29	BW	NW	8-C-52279
30	NW	27/8 API	8-C-52280
31	NW	31/2 API	8-C-52281
32	EW	EW	8-C-52282
33	AW	AW	8-C-52283
34	BW	BW	8-C-52284
35	NW	NW	8-C-52285
36	EW	AW	8-C-52286
37	AW	BW	8-C-52287
38	AW	NW	8-C-52288
39	BW	NW	8-C-52289
40	EW	EW	8-C-52290
41	AW	AW	8-C-52291
42	BW	BW	8-C-52292
43	NW	NW	8-C-52293



4. Coples

4.2 DIMENSIONES DE PERFORACIÓN ROD (NOMINAL)

Tamaño ROD	"O" DIÁMETRO FUERA		"I" DIÁMETRO DENTRO		"B" ACOPLA- MIENTO		"R" DIÁMETRO RAÍZ		"L" HILO DURACIÓN		HILOS TPI	PESO 10 FT.	
	IN	MM	IN	MM	IN	MM	IN	MM	IN	MM	PER IN.	LB	KG
E	1 5/16	33.3	27/32	21.4	7/16	11.1	7/8	22.2	1 1/2	38.1	3	28	12.7
A	1 5/8	41.3	1 1/8	38.6	9/16	14.3	1 9/64	29.0	1 3/4	44.5	3	38	17.2
B	1 29/32	48.4	1 13/32	35.7	5/8	15.9	1 1/4	31.8	1 7/8	47.6	5	46	21.0
N	2 3/8	60.3	2	50.8	1	25.4	1 11/16	42.9	2 3/8	60.3	4	49	22.2
RW	1 3/32	27.8	23/32	18.3	23/32	18.2	3/4	19.1	1 1/4	37.8	4	19	8.6
EW	1 3/8	34.9	7/8	22.2	7/16	11.1	15/16	23.8	1 9/16	39.7	3	31	14.1
AW	1 3/4	44.5	1 7/32	30.9	5/8	15.9	1 1/4	31.8	1 7/8	47.6	3	44	20.0
AWML	1 3/4	44.5	1 3/8	34.9	5/8	15.9	--	--	1 3/4	44.5	5	33	15.0
BW	2 1/8	54.0	1 3/4	44.5	3/4	19.1	1 17/32	38.9	2 1/4	57.2	3	42	19.1
NW	2 5/8	66.7	2 1/4	57.2	1 3/8	34.9	2	50.8	2 3/4	69.9	3	54	24.5
NWML	2 5/8	66.7	2 1/4	57.2	1 1/8	28.6	--	--	2 9/16	65.1	4	60	27.2
HW	3 1/2	88.9	3 1/16	77.8	2 3/8	60.3	2 27/32	72.2	3 9/32	83.3	3	85	38.6

4. Coples

4.3 COPLES ADAPTORES

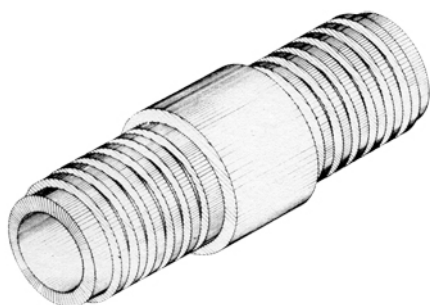

Cople Adaptador				
1	NW ESPIGA	A	NW ESPIGA	7-C-52294
2	NW ESPIGA	A	AW ESPIGA	7-C-52295
3	NW ESPIGA	A	AQWL ESPIGA	7-C-52296
4	NW ESPIGA	A	BW ESPIGA	7-C-52297
5	NW ESPIGA	A	BW ESPIGA	7-C-52298
6	NW ESPIGA	A	BQWL ESPIGA	7-C-52299
7	NW ESPIGA	A	NX CAJA	7-C-52300
8	NW ESPIGA	A	NW ESPIGA	7-C-52301
9	NW ESPIGA	A	NQWL ESPIGA	7-C-52302
10	NW ESPIGA	A	NQWL ESPIGA	7-C-52303

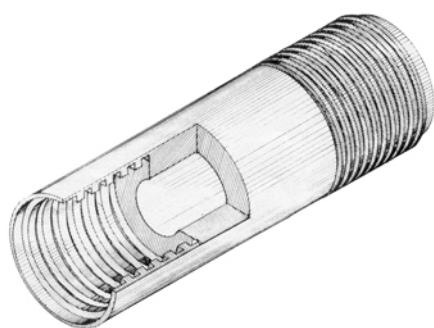

Cople Adaptador				
11	AW-H	AW 2 3/8"	API-REG-H	7-C-52294
12	BW-H	BW 2 3/8"	API-REG-H	7-C-52295
13	NW-H	BW 2 3/8"	API-REG-H	7-C-52296
14	AW-H	NX 3 1/2"	API-REG-H	7-C-52297
15	AW	NX 3 1/2"	API-REG-H	7-C-52298
16	BW-H	BW 3 1/2"	API-REG-H	7-C-52299
17	BW	BW 3 1/2"	API-REG-H	7-C-52300
18	BW	NX 4 1/2"	API-REG-H	7-C-52301
19	NW	NX 4 1/2"	API-REG-H	7-C-52302

4. Coples

Información del Hilo del Taladro

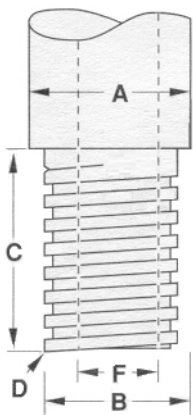
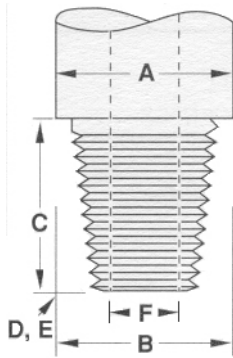

A	Fuera de un diámetro
AA	Diámetro exterior de la casilla
B	Diámetro principal del Hilo
C	Longitud de Patillas
D	Hilos por Pulgada
E	Taper por el Pie
F	Herramienta conjunta Bore

TOLL JOINTS							
	ABREVIACIÓN	A	B	C	D	E	F
2 3/8 API REGULAR	2 3/8 Reg	3 1/8 "	2 5/8"	3"	5	3"	1"
2 7/8 API REGULAR	2 7/8 Reg	3 3/4"	3"	3 1/2"	5	3"	1 1/4"
3 1/2 API REGULAR	3 1/2 Reg	4 1/2"	3 1/2"	3 3/4"	5	3"	1 1/2"
4 1/2 API REGULAR	4 1/2 Reg	5 1/2"	4 5/8"	4 1/4"	5	3"	2 1/4"
5 1/2 API REGULAR	5 1/2 Reg	6 3/4"	5 33/64"	4 3/4"	4	3"	2 3/4"
6 5/8 API REGULAR	6 5/8 Reg	7 3/4"	6"	5"	4	2"	3 1/2"
7 5/8 API REGULAR	7 5/8 Reg	8 7/8"	7"	5 1/4"	4	3"	4"
2 3/8 API INTERNAL FLUSH	2 3/8 IF	3 1/2"	2 7/8"	3"	4	2"	1 3/4"
2 3/8 API INTERNAL FLUSH LH	2 3/8 IF LH	3 1/2"	2 7/8"	3"	4	2"	1 3/4"
2 7/8 API INTERNAL FLUSH	2 7/8 IF	4 1/2"	3 25/64"	3 1/2"	4	2"	2 1/8"
2 7/8 API INTERNAL FLUSH LH	2 7/8 IF LH	4 1/2"	3 25/64"	3 1/2"	4	2"	2 1/2"
3 1/2 API INTERNAL FLUSH	3 1/2 IF	4 3/4"	4 1/64"	4"	4	2"	2 11/16"
3 1/2 API INTERNAL FLUSH LH	3 1/2 IF LH	4 3/4"	4 1/64"	4"	4	2"	2 11/16"
4 API INTERNAL FLUSH	4 IF	5 3/4"	4 53/64"	4 1/2"	4	2"	3 1/4"

4. Coples

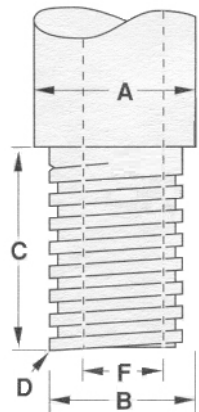
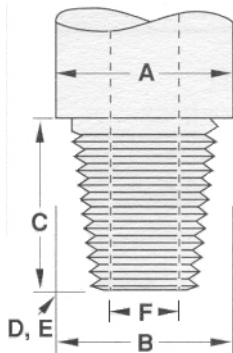

TOLL JOINTS							
	ABREVIACIÓN	A	B	C	D	E	F
4 1/2 API INTERNAL FLUSH	4 1/2 IF	6 1/8"	5 1/4"	4 1/2"	4	2"	3 3/4"
2 3/8 MAYHEW JUNIOR	2 3/8 MJ	2 7/8"	2 21/64"	2 1/4"	4	2"	1 1/2"
2 3/8 MAYHEW REGULAR	2 3/8 MR	3 1/4"	2 35/64"	3"	4	1 1/2"	1 5/8"
2 3/8 JOY FULL HOLE	2 3/8 Joy FH	3 1/8"	2 35/64"	3"	4	1 1/2"	1 5/8"
2 3/8 FAILING EXPLORATION	2 3/8 FEDP	2 31/32"	2 1/2"	2 3/4"	4	2"	1 1/2"
2 7/8 FAILING EXPLORATION	2 7/8 FEDP	3 3/4"	3 1/8"	3 1/4"	4	2"	1 7/8"
3 1/2 API FULL HOLE	3 1/2 FH	4 5/8"	4"	3 3/4"	5	3"	2 1/8"
4" API FULL HOLE	4" FH	5 1/4"	4 9/32"	4 1/2"	4	2"	2 13/16"
4 1/2 API FULL HOLE	4 1/2 FH	5 3/4"	4 51/64"	4"	5	3"	3"

FLUSH JOINT STRAIGHT THREAD								
	ABBREVIATION	A	B	C	D	E	F	
A	E-ROD	E-Rod	1 5/16"	1"	1 1/2"	3	None	7/16"
AA	EW-ROD	EW-Rod	1 3/8"	1 1/16"	1 9/16"	3	None	7/16"
B	A-ROD	A-Rod	1 5/8"	1 17/64"	1 3/4"	3	None	9/16"
C	AW-ROD	AW-Rod	1 3/4"	1 3/8"	1 7/8"	3	None	5/8"
D	B-ROD	B-Rod	1 29/32"	1 13/32"	1 7/8"	5	None	5/8"
E	BW-ROD	BW-Rod	2 1/8"	1 11/16"	2 1/4"	3	None	3/4"
F	N-ROD	4 Thread N-Rod	2 3/8"	1 7/8"	2 3/8"	4	None	1"
	N-ROD FAILING TYPE	3 Thread N-Rod	2 3/8"	1 7/8"	2 3/8"	3	None	1 1/8"
	NW-ROD	NW-Rod	2 5/8"	2 7/32"	2 3/4"	3	None	1 3/8"

A	Fuera de un diámetro
AA	Diámetro exterior de la casilla
B	Diámetro principal del Hilo
C	Longitud de Patillas
D	Hilos por Pulgada
E	Taper por el Pie
F	Herramienta conjunta Bore

4. Coples

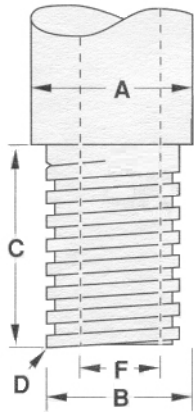
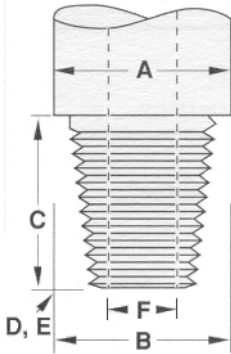

A	Fuera de un diámetro
AA	Diámetro exterior de la casilla
B	Diámetro principal del Hilo
C	Longitud de Patillas
D	Hilos por Pulgada
E	Taper por el Pie
F	Herramienta conjunta Bore

CABLE TOOL DRILING JOINTS							
	ABBREVIATION	A	AA	B	C	D	E
1 1/8 X 1 3/4 API	1 3/4 API	2 1/2"	2 5/8"	1 3/4"	2 1/2"	8	3"
1 1/2 X 2 1/4 API	2 1/4 API	3 1/8"	3 1/4"	2 1/4"	3"	8	3"
1 5/8 X 2 5/8 API	2 5/8 API	3 5/8"	3 3/4"	2 5/8"	3 1/2"	7	3"
2 X 3 API	3 API	4 1/4"	4 3/8"	3"	4"	7	3"
2 1/4 X 3 1/4 API	3 1/4 API	4 1/2"	4 3/4"	3 1/4"	4"	7	3"
2 1/2 X 3 1/2 API	3 1/2 API	5"	5 1/4"	3 1/2"	4 1/4"	7	3"
2 3/4 X 3 3/4 API	3 3/4 API	5 1/4"	5 1/2"	3 3/4"	4 1/2"	7	3"
3 1/4 X 4 1/4 API	4 1/4 API	6 1/4"	6 1/2"	4 1/4"	5"	7	3"
3 1/2 X 4 1/2 API	4 1/2 API	6 1/2"	6 3/4"	4 1/2"	5 1/2"	7	3"
4 X 5 API	5 API	7"	7 3/8"	5"	5 1/2"	7	3"
4 1/4 X 6 API	6 API	8 1/4"	8 5/8"	6"	7"	7	3"